

K2 tubular cable lug - straight

not insulated



Tubular cable lug K2

Non-insulated tubular cable lugs in eye type design. High definition version for reliable crimping.

Material

Copper
Surface: tinned

Properties

- Without inspection hole

Note

Also available in angulated version (45° and 90°).

Technical data

Temperature range: up to +120°C

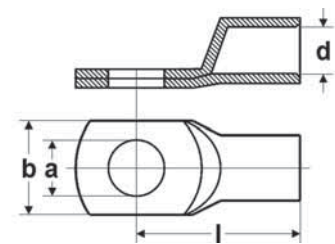

Abmessungen

- a Diameter of the boring
- d Inner diameter of the cable insertion
- b Flange width
- l Length till middle of the boring

eye type

Part no.	Type	Cross-section mm ²	a mm	d mm	b mm	l mm	Code type	Weight kg / 1000 items	Unit	Net EUR/100 items at a purchase of		
										up to 500	501 - 1000	1001 - 5000
904517	K2 6-5	6,0	5,5	3,5	10,0	21,0	-	5,0	100	o. r.	o. r.	o. r.
904518	K2 6-6	6,0	6,5	3,5	12,0	21,0	-	4,7	100	o. r.	o. r.	o. r.
904519	K2 6-8	6,0	8,5	3,5	15,0	23,0	-	5,4	100	o. r.	o. r.	o. r.
904520	K2 6-10	6,0	10,5	3,5	17,0	25,0	-	5,9	100	o. r.	o. r.	o. r.
904521	K2 6-12	6,0	13,0	3,5	19,0	28,0	-	6,3	100	o. r.	o. r.	o. r.
904522	K2 10-5	10,0	5,5	4,5	12,0	22,0	-	5,0	100	o. r.	o. r.	o. r.
904523	K2 10-6	10,0	6,5	4,5	12,0	22,0	-	4,9	100	o. r.	o. r.	o. r.
904524	K2 10-8	10,0	8,5	4,5	15,0	25,0	-	5,8	100	o. r.	o. r.	o. r.
904525	K2 10-10	10,0	10,5	4,5	17,0	27,0	-	6,2	100	o. r.	o. r.	o. r.
904526	K2 10-12	10,0	13,0	4,5	19,0	29,0	-	6,4	100	o. r.	o. r.	o. r.
904527	K2 16-5	16,0	5,5	5,5	12,0	26,0	-	8,4	100	o. r.	o. r.	o. r.
904528	K2 16-6	16,0	6,5	5,5	12,0	27,0	-	8,6	100	o. r.	o. r.	o. r.
904529	K2 16-8	16,0	8,5	5,5	15,0	29,0	-	9,3	100	o. r.	o. r.	o. r.
904530	K2 16-10	16,0	10,5	5,5	17,0	31,0	-	9,9	100	o. r.	o. r.	o. r.
904531	K2 16-12	16,0	13,0	5,5	19,0	33,0	-	10,2	100	o. r.	o. r.	o. r.
904532	K2 25-5	25,0	5,5	7,0	14,0	30,0	-	12,2	25	o. r.	o. r.	o. r.
904533	K2 25-6	25,0	6,5	7,0	14,0	30,0	-	12,0	100	o. r.	o. r.	o. r.
904534	K2 25-8	25,0	8,5	7,0	16,0	32,0	-	13,1	100	o. r.	o. r.	o. r.
904535	K2 25-10	25,0	10,5	7,0	18,0	34,0	-	15,7	100	o. r.	o. r.	o. r.
904536	K2 25-12	25,0	13,0	7,0	19,0	35,0	-	13,9	25	o. r.	o. r.	o. r.
904537	K2 25-14	25,0	15,0	7,0	21,0	38,0	-	14,9	25	o. r.	o. r.	o. r.
904538	K2 35-6	35,0	6,5	8,5	17,0	32,0	-	18,5	100	o. r.	o. r.	o. r.
904539	K2 35-8	35,0	8,5	8,5	17,0	34,0	-	20,0	100	o. r.	o. r.	o. r.
904540	K2 35-10	35,0	10,5	8,5	19,0	37,0	-	21,3	100	o. r.	o. r.	o. r.
904541	K2 35-12	35,0	13,0	8,5	21,0	38,0	-	21,2	100	o. r.	o. r.	o. r.
904542	K2 35-14	35,0	15,0	8,5	21,0	40,0	-	21,8	25	o. r.	o. r.	o. r.
904543	K2 35-16	35,0	17,0	8,5	26,0	42,0	-	22,4	25	o. r.	o. r.	o. r.

Continuation ▶

o. r. = on request

K2 tubular cable lug - straight



not insulated

eye type

Part no.	Type	Cross-section mm ²	a mm	d mm	b mm	l mm	Code type	Weight kg / 1000 items	Unit	Net EUR/100 items at a purchase of		
										up to 500	501 - 1000	1001 - 5000
904544	K2 50-6	50,0	6,5	10,0	20,0	37,0	-	30,0	25	o. r.	o. r.	o. r.
904545	K2 50-8	50,0	8,5	10,0	20,0	37,0	-	29,3	50	o. r.	o. r.	o. r.
904546	K2 50-10	50,0	10,5	10,0	20,0	39,0	-	30,8	50	o. r.	o. r.	o. r.
904547	K2 50-12	50,0	13,0	10,0	23,0	43,0	-	32,3	50	o. r.	o. r.	o. r.
904548	K2 50-14	50,0	15,0	10,0	23,0	45,0	-	33,2	25	o. r.	o. r.	o. r.
904549	K2 50-16	50,0	17,0	10,0	28,0	46,0	-	33,8	25	o. r.	o. r.	o. r.
904550	K2 50-20	50,0	21,0	10,0	30,0	48,0	-	34,6	25	o. r.	o. r.	o. r.
904551	K2 70-6	70,0	6,5	12,0	23,0	43,0	-	44,9	25	o. r.	o. r.	o. r.
904552	K2 70-8	70,0	8,5	12,0	23,0	43,0	-	43,8	50	o. r.	o. r.	o. r.
904553	K2 70-10	70,0	10,5	12,0	23,0	44,0	-	45,4	50	o. r.	o. r.	o. r.
904554	K2 70-12	70,0	13,0	12,0	23,0	46,0	-	46,3	50	o. r.	o. r.	o. r.
904555	K2 70-14	70,0	15,0	12,0	23,0	48,0	-	47,6	25	o. r.	o. r.	o. r.
904556	K2 70-16	70,0	17,0	12,0	28,0	50,0	-	42,4	25	o. r.	o. r.	o. r.
904557	K2 70-20	70,0	21,0	12,0	30,0	53,0	-	50,9	25	o. r.	o. r.	o. r.
904558	K2 95-8	95,0	8,5	13,5	26,0	48,0	-	54,4	25	o. r.	o. r.	o. r.
904559	K2 95-10	95,0	10,5	13,5	26,0	48,0	-	54,0	50	o. r.	o. r.	o. r.
904560	K2 95-12	95,0	13,0	13,5	26,0	49,0	-	55,6	50	o. r.	o. r.	o. r.
904561	K2 95-14	95,0	15,0	13,5	26,0	51,0	-	56,2	25	o. r.	o. r.	o. r.
904562	K2 95-16	95,0	17,0	13,5	28,0	54,0	-	58,2	50	o. r.	o. r.	o. r.
904563	K2 95-20	95,0	21,0	13,5	36,0	60,0	-	67,1	25	o. r.	o. r.	o. r.
904564	K2 120-8	120,0	8,5	15,0	28,0	51,0	-	67,2	25	o. r.	o. r.	o. r.
904565	K2 120-10	120,0	10,5	15,0	28,0	51,0	-	65,7	50	o. r.	o. r.	o. r.
904566	K2 120-12	120,0	13,0	15,0	28,0	51,0	-	63,8	50	o. r.	o. r.	o. r.
904567	K2 120-14	120,0	15,0	15,0	28,0	52,0	-	64,5	25	o. r.	o. r.	o. r.
904568	K2 120-16	120,0	17,0	15,0	30,0	54,0	-	65,1	50	o. r.	o. r.	o. r.
904569	K2 120-20	120,0	21,0	15,0	36,0	63,0	-	77,4	25	o. r.	o. r.	o. r.
904570	K2 150-8	150,0	8,5	16,5	31,0	56,0	-	77,8	10	o. r.	o. r.	o. r.
904571	K2 150-10	150,0	10,5	16,5	31,0	56,0	-	76,2	10	o. r.	o. r.	o. r.
904572	K2 150-12	150,0	13,0	16,5	31,0	57,0	-	77,3	25	o. r.	o. r.	o. r.
904573	K2 150-14	150,0	15,0	16,5	31,0	57,0	-	76,4	10	o. r.	o. r.	o. r.
904574	K2 150-16	150,0	17,0	16,5	31,0	58,0	-	75,3	10	o. r.	o. r.	o. r.
904575	K2 150-20	150,0	21,0	16,5	36,0	66,0	-	88,0	10	o. r.	o. r.	o. r.
904576	K2 185-10	185,0	10,5	19,0	35,0	65,0	-	117,5	10	o. r.	o. r.	o. r.
904577	K2 185-12	185,0	13,0	19,0	35,0	65,0	-	118,2	10	o. r.	o. r.	o. r.
904578	K2 185-14	185,0	15,0	19,0	35,0	65,0	-	113,9	10	o. r.	o. r.	o. r.
904579	K2 185-16	185,0	17,0	19,0	35,0	65,0	-	112,4	25	o. r.	o. r.	o. r.
904580	K2 185-20	185,0	21,0	19,0	39,0	69,0	-	120,0	10	o. r.	o. r.	o. r.
904581	K2 240-10	240,0	10,5	21,0	39,0	72,0	-	147,2	10	o. r.	o. r.	o. r.
904582	K2 240-12	240,0	13,0	21,0	39,0	72,0	-	145,5	10	o. r.	o. r.	o. r.
904583	K2 240-14	240,0	15,0	21,0	39,0	72,0	-	142,4	10	o. r.	o. r.	o. r.
904584	K2 240-16	240,0	17,0	21,0	39,0	72,0	-	140,9	25	o. r.	o. r.	o. r.
904585	K2 240-20	240,0	21,0	21,0	39,0	72,0	-	136,0	10	o. r.	o. r.	o. r.
904586	K2 300-12	300,0	13,0	23,5	43,0	87,0	-	233,3	5	o. r.	o. r.	o. r.
904587	K2 300-14	300,0	15,0	23,5	43,0	87,0	-	231,4	5	o. r.	o. r.	o. r.
904588	K2 300-16	300,0	17,0	23,5	43,0	87,0	-	227,4	5	o. r.	o. r.	o. r.
904589	K2 300-20	300,0	21,0	23,5	43,0	87,0	-	221,9	5	o. r.	o. r.	o. r.
904590	K2 400-12	400,0	13,0	27,0	49,0	90,0	-	324,1	5	o. r.	o. r.	o. r.
904591	K2 400-14	400,0	15,0	27,0	49,0	90,0	-	322,4	5	o. r.	o. r.	o. r.
904592	K2 400-16	400,0	17,0	27,0	49,0	90,0	-	319,8	5	o. r.	o. r.	o. r.
904593	K2 400-20	400,0	21,0	27,0	49,0	90,0	-	314,1	5	o. r.	o. r.	o. r.

Dimensions and specifications may be changed without prior notice.

o. r. = on request