

# KAC AL/CU-compression cable lug - straight

not insulated

new

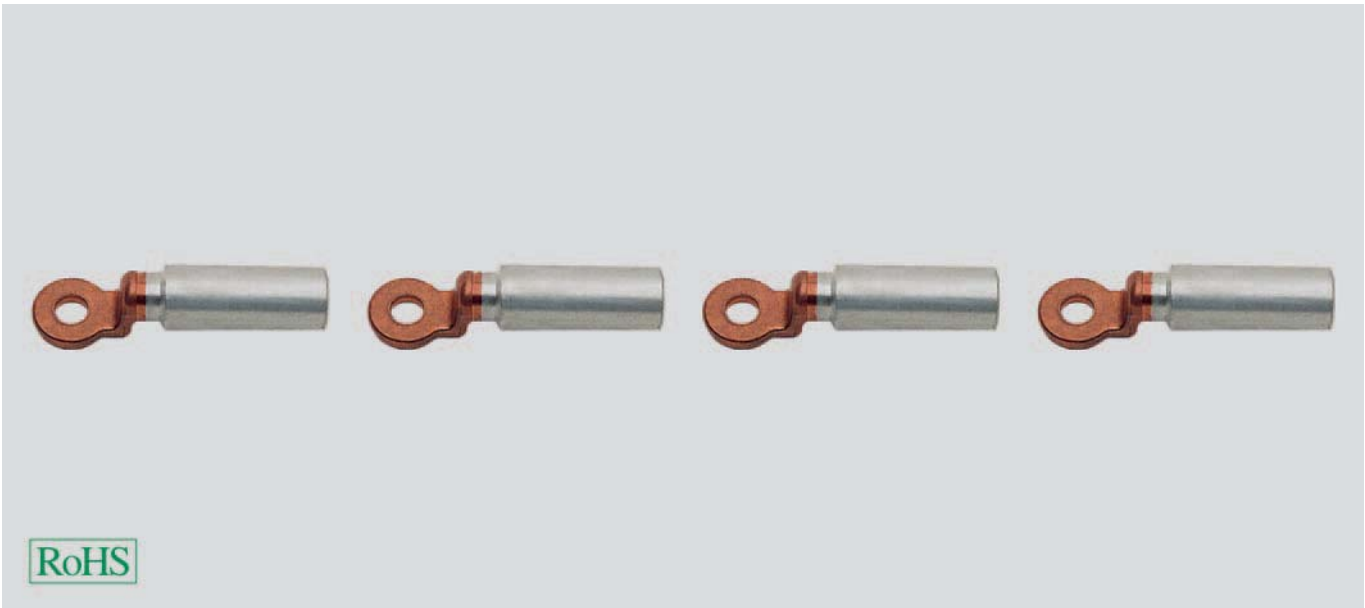

## Tubular cable lug KAC

Non-insulated, straight tubular cable lugs in eye type design made by aluminium. High definition version for reliable crimping. Barrier design with oil stop with solid copper screw-on palm.

## Material

Aluminium / copper  
Surface: bare

## Note

Code type indicates the required hexagonal clamping insert.

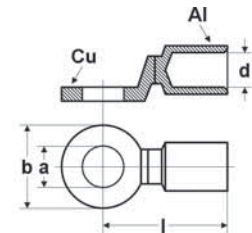

## Diameter

- a Diameter of the boring
- d Inner diameter of the cable inclusion
- b Flange width
- l Length till middle of the boring

## eye type

Part no.	Type	Cross-section mm <sup>2</sup>	a mm	d mm	b mm	l mm	Code type	Cu-Weight kg / 1000 items	Unit	Net EUR/100 items at a purchase of		
										up to 500	501 - 1000	1001 - 5000
906021	KAC 16-8	16,0	8,5	6,0	25,0	67,5	12,0	44,0	10	o. r.	o. r.	o. r.
906022	KAC 16-10	16,0	10,5	6,0	25,0	67,5	12,0	42,0	10	o. r.	o. r.	o. r.
906023	KAC 25-8	25,0	8,5	6,8	25,0	67,5	12,0	44,0	10	o. r.	o. r.	o. r.
906024	KAC 25-10	25,0	10,5	6,8	25,0	67,5	12,0	42,0	10	o. r.	o. r.	o. r.
906025	KAC 25-12	25,0	13,0	6,8	25,0	67,5	12,0	39,0	10	o. r.	o. r.	o. r.
906026	KAC 35-8	35,0	8,5	8,0	25,0	76,5	14,0	44,0	10	o. r.	o. r.	o. r.
906027	KAC 35-10	35,0	10,5	8,0	25,0	76,5	14,0	42,0	10	o. r.	o. r.	o. r.
906028	KAC 35-12	35,0	13,0	8,0	25,0	76,5	14,0	38,0	10	o. r.	o. r.	o. r.
906030	KAC 50-10	50,0	10,5	9,8	25,0	76,5	16,0	42,0	10	o. r.	o. r.	o. r.
906029	KAC 50-8	50,0	8,5	9,8	25,0	76,5	16,0	44,0	10	o. r.	o. r.	o. r.
906031	KAC 50-12	50,0	13,0	9,8	25,0	76,5	16,0	39,0	10	o. r.	o. r.	o. r.
906032	KAC 70-10	70,0	10,5	11,2	25,0	84,5	18,0	42,0	10	o. r.	o. r.	o. r.
906033	KAC 70-12	70,0	13,0	11,2	25,0	84,5	18,0	39,0	10	o. r.	o. r.	o. r.
906035	KAC 95-12	95,0	13,0	13,2	30,0	90,5	22,0	68,0	10	o. r.	o. r.	o. r.
906034	KAC 95-10	95,0	10,5	13,2	30,0	90,5	22,0	74,0	10	o. r.	o. r.	o. r.
906036	KAC 95-16	95,0	17,0	13,2	30,0	90,5	22,0	64,0	10	o. r.	o. r.	o. r.
906037	KAC 120-12	120,0	13,0	14,7	30,0	92,0	22,0	68,0	5	o. r.	o. r.	o. r.
906038	KAC 120-16	120,0	17,0	14,7	30,0	92,0	22,0	64,0	5	o. r.	o. r.	o. r.
906039	KAC 150-12	150,0	13,0	16,3	30,0	104,0	25,0	68,0	5	o. r.	o. r.	o. r.
906040	KAC 150-16	150,0	17,0	16,3	30,0	104,0	25,0	64,0	5	o. r.	o. r.	o. r.
906041	KAC 150-20	150,0	21,0	16,3	35,0	107,5	25,0	101,0	5	o. r.	o. r.	o. r.
906042	KAC 185-10	185,0	10,5	18,3	30,0	105,0	28,0	103,0	5	o. r.	o. r.	o. r.
905020	KAC 185-12	185,0	13,0	18,3	30,0	105,0	28,0	101,0	5	o. r.	o. r.	o. r.
905383	KAC 185-16	185,0	17,0	18,3	30,0	105,0	28,0	93,0	5	o. r.	o. r.	o. r.
906043	KAC 185-20	185,0	21,0	18,3	35,0	107,5	28,0	101,0	5	o. r.	o. r.	o. r.
906044	KAC 240-10	240,0	10,5	21,0	35,0	118,5	32,0	121,0	5	o. r.	o. r.	o. r.
905294	KAC 240-12	240,0	13,0	21,0	35,0	118,5	32,0	118,0	5	o. r.	o. r.	o. r.
906045	KAC 240-16	240,0	17,0	21,0	35,0	118,5	32,0	110,0	5	o. r.	o. r.	o. r.
906046	KAC 240-20	240,0	21,0	21,0	35,0	118,5	32,0	101,0	5	o. r.	o. r.	o. r.
904850	KAC 300-12	300,0	13,0	23,3	40,0	123,5	34,0	177,0	1	o. r.	o. r.	o. r.
906047	KAC 300-16	300,0	17,0	23,3	40,0	123,5	34,0	169,0	1	o. r.	o. r.	o. r.
906048	KAC 300-20	300,0	21,0	23,3	40,0	123,5	34,0	160,0	1	o. r.	o. r.	o. r.

Dimensions and specifications may be changed without prior notice.

o. r. = on request